

# HandiMatic Technical Data



### Description:

Angle-patterned or in-line model, filter screen on inside of the element

### Applications:

- All water intakes
- Cooling-water systems
- Re-circulation systems
- Watertransport systems
- After media filters
- Distribution systems
- Sprinkler systems

### Materials:

- Polyester coated steel
  - Neoprene rubbers
  - PVC elements with st.st. filter screen
- Perforation: 100, 130, 200, 300, 435 and 800 microns (other perforations on request)

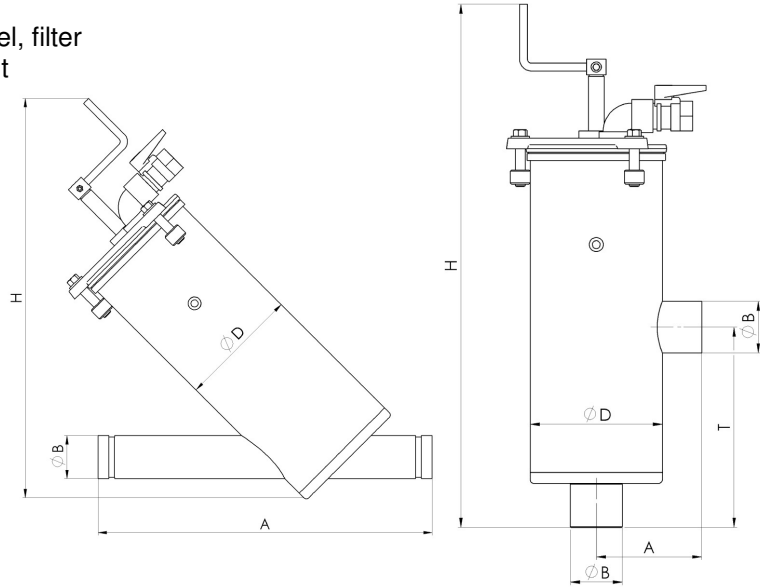

Type	Unit	784102F	784202F	784103F	784203F	784104F
<b>Description</b>		angle-patterned	in-line	angle-patterned	in-line	angle-patterned
<b>Connection ØB</b>	inch	2"	2"	3"	3"	4"
<b>Diameter ØD</b>	inch	6"	6"	6"	6"	8"
<b>Capacity</b>	m <sup>3</sup> /h	25	25	40	40	80
<b>Flange (ISO 7005 PN16)</b>						
<b>Bolt circle dia. C</b>	mm	125	125	160	160	180
<b>Bolt holes</b>	mm	4*Ø18	4*Ø18	8*Ø18	8*Ø18	8*Ø18
<b>Length A</b>	mm	-	475	-	555	-
<b>H</b>	mm	675	575	675	590	895
<b>T</b>	mm	255	-	275	-	400
<b>A</b>	mm	139	-	139	-	190
<b>Filtering area</b>	cm <sup>2</sup>	1000	1000	1000	1000	2100
<b>Weight</b>	kg	16	17	17	20	32
<b>Min. Flushing pressure</b>	bar	2	2	2	2	2
<b>Working pressure</b>	bar	8	8	8	8	8
<b>Max. Pressure</b>	bar	10	10	10	10	10
<b>Flushing capacity</b>	m <sup>3</sup> /h	2-3	2-3	2-3	2-3	3-5.5



Subject to changes and/or misprints