

# RAM Control Valves



## RAM Valve

The **Bermad** RAM 400 Series is a series of hydraulically-operated, diaphragm-actuated control valves with an internationally patented and registered design.

Its construction combines simplicity and reliability. It practically does not have any of the limitations normally associated with these kinds of products.

The valve has been designed to control various types of irrigation, distribution and industrial systems.

## Product features:

Very high flow capacity of the water at low pressure losses.

Exceptional stability in closing or in controlling the pressure. Absolutely no surges.

The valve opens at a low inlet pressure.

Highly balanced diaphragm without deformation due to unequal hydraulic forces at closure or when setting.

Maintenance-friendly.

## Models:

The RAM valve is available with a wide selection of regulators, controllers and accessories

- Model 405: hydraulically-operated valve
- Model 410: electrically-operated valve
- Model 420: pressure-reducing valve
- Model 430: pressure-sustaining valve
- Model 430Q: pressure-relief valve
- Model 450: float-controlled valve
- Model 470: flow-limiting valve
- Model 400F: fire-protection valve (FM approval, UL listed)

Additional possibilities and combinations are available.

Options: flow-regulating stem, valve-position indicator and combinations of functions.



UVAR

Subject to changes and/or misprints



# RAM valve Technical Data

### Materials brass series:

Sizes (straight): 3/4", 1", 1 1/2" and 2"  
 Connections : BSP female thread  
 Pressure level : ISO PN 10, ANSI 125  
 Working pressure : 0,5-10 bar  
 Temperature : water up till 80 °C  
 Body and lid : messing  
 Diaphragm : with nylon reinforced NR  
 Spring : St.st.

### Cross-section:

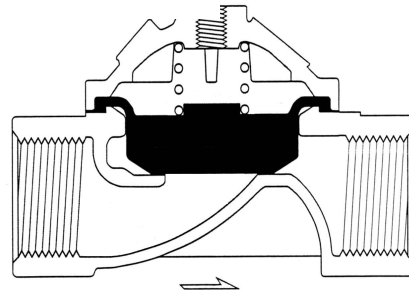

### Flow diagram:

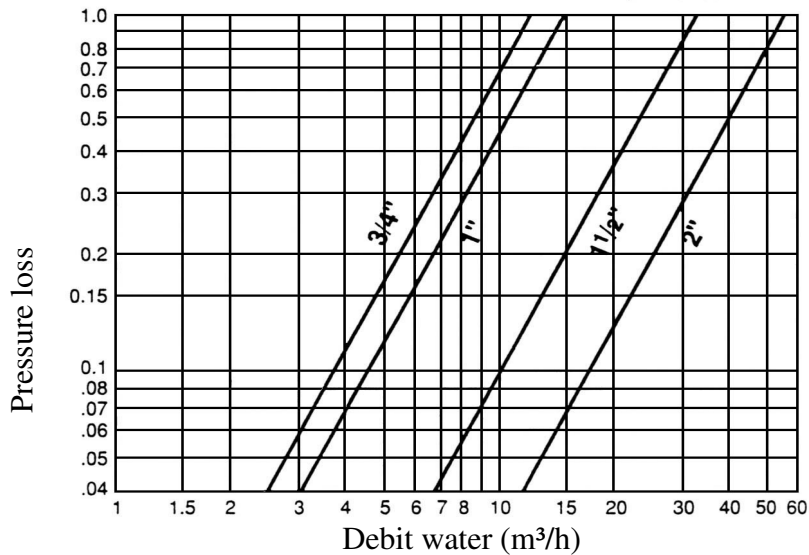

### Dimensions and weights:

Design	Unit	3/4"	1"	1 1/2"	2"
Type nr.		40907M1	40910M1	40915M1	40920M1
Connection	inch	3/4"	1"	1 1/2"	2"
L	mm	112	112	150	180
H	mm	67,5	67,5	83	110
R	mm	20	20	27,5	38
Width	mm	72	72	90	120
Weight	kg	0,95	0,95	1,5	4

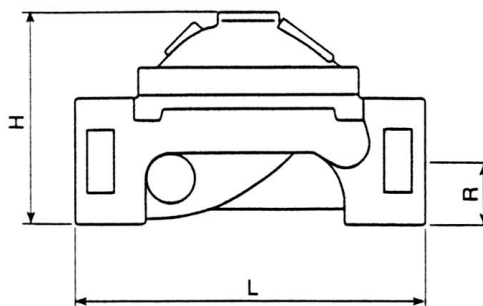

UVAR

Subject to changes and/or misprints

# RAM valve Technical Data



### Materials cast iron series:

Sizes (straight): 2", 2½", 3"R, 3", 4", 6", 8", 10" and 12"

(angle-patterned): 2", 3", 4"

Connections : 2", 2½", 3"R, 3" : BSP female thread

2", 2½", 3"R, 3", 4", 6", 8", 10", 12" flange ISO: PN16, ANSI: 125, BS-D

Working pressure : 0,5 -10 kg/cm<sup>2</sup> (Option: up till 16 bar)

Temperature : water up till 80°C

Body and lid : cast iron, polyester coating

Spring : RVS

Diaphragm : with nylon reinforced NR (natural rubber); options: Nitril, Buna N, EPDM

Option : with manual valve

### Dimensions and weights:

Straight design		Unit				Thread				Flange					
Connection	Unit	2"	2½"	3"R	3"	2"	2½"	3"R	3"	4"	6"	8"	10"	12"	
L	mm	180	210	210	255	205	205	210	250	320	415	500	605	724	
H	mm	111	133	140	160	155	178	187	210	242	345	430	460	635	
R	mm	38	46	55	55	78	89	100	100	112	140	170	202	240	
Width	mm	120	129	129	175	155	178	200	200	223	306	365	405	580	
Weight	kg	4	5,7	5,8	13	9	10,5	12,1	19	28	68	125	144	290	
Angle-patterned design		Thread				Flange									
Connection	Unit	2"	3"			2"	3"	4"							
L	mm	70	110			121	153	160							
H	mm	119	184			157	200	223							
R	mm	38	55			83	100	112							
Width	mm	118	170			155	200	223							
Weight	kg	4,4	11			9,0	17	26							

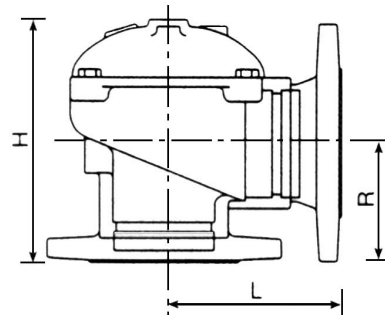
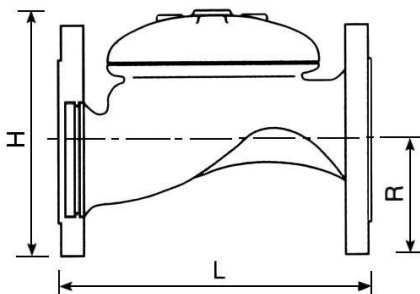

Subject to changes and/or improvements