

Bermadon



Bermadon

The Bermadon automatically admits a preset amount of water and then shuts off the supply line.

The amount required is set with the knob on the Bermadon.

The internal mechanism driven by the water-volume flow counts backwards to the supply shut-off point.

This prevents excess water from passing through, thus avoiding any waste.

Any quantity can be set within the scale range.

The Bermadon operates without electricity and/or timer, and delivers exactly the amount that is needed!

The inside of plastic and stainless steel is of high quality for a reliable operation.

Pressure variations and/or flow-rate differences do not influence this process.

In the case of soiled water, a prefilter is to be installed.

Product features:

Simple design without needing any provisions for electricity.

Reliable and accurate operation.

The amount of water being delivered is independent of pressure variations.

Easy to install in any position desired.

Saves water and protects against excess water by automatic cut-off.

Applications:

- Watering lawns
- For small irrigation systems
- Filling water storage tanks
- Providing cattle with drinking water





Bermadons Technical Data

Specifications:

Sizes: 1"
 Connections: BSP male thread
 Material: - housing, cover and gears: plastic
 - Shafts and springs: st.st.
 Rubbers: EPDM & NBR
 Working pressures: 0,5-6 kg/cm²
 Temperature: water up till 80° C
 Tolerances: 2% of maximum adjusting range and
 4% of the institutions (according to ISO 7714 class 3)

Flow diagram:

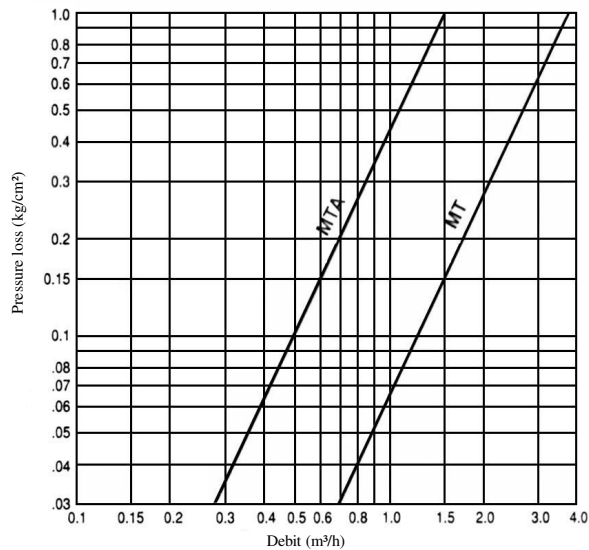

Capacities, dimensions and weights:

Designs	Unit	MT	MTA
Type		2U9T10...	2U9A10...
Connection	inch	1"	1"
Capacity: minimum	m ³ /h	0,5	0,1
	nominal	m ³ /h	3,0
maximum	m ³ /h	5,0	2,0
	Adjusting range(max.)		
L	ltr	100	50
	ltr	1000	500
	ltr	2000	2000
	m ³ /h	4	4
	m ³ /h	10	8
	m ³ /h	20	
H	m ³ /h	50	
	mm	166	166
R	mm	145	145
	mm	25	25
Width	mm	100	100
Weight	kg	0,65	0,65

when ordering: specify choice of adjusting range with order number

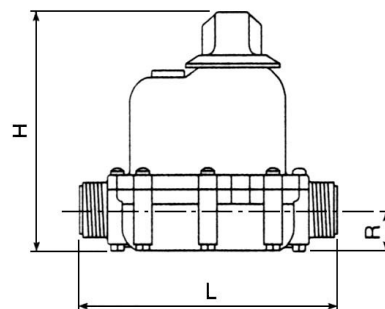

UVAR

Subject to changes and/or misprints